

# Sliding brackets

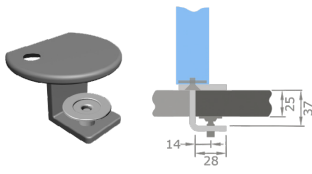

## SB25

- Used when attaching around a desktop and leg frame.
- Usable jaw size of 17-33mm.
- Supplied with pressure pad fixings.
- Not to be used with screen hung monitor arms.

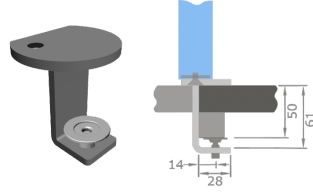

## SB50

- For use when attaching to a single desktop.
- Usable jaw size of 44-57mm.
- Supplied with pressure pad fixings.
- Not to be used with screen hung monitor arms.

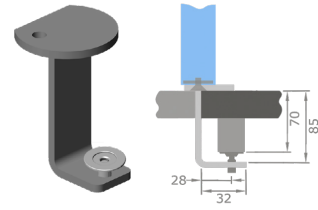

## SB70

- For use when attaching to a single desktop.
- Usable jaw size of 67-80mm.
- Supplied with pressure pad fixings.
- Not to be used with screen hung monitor arms.

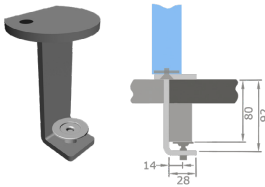

## SB80

- Used when attaching around a desktop and leg frame.
- Usable jaw size of 74-87mm.
- Supplied with pressure pad fixings.
- Not to be used with screen hung monitor arms.

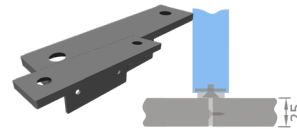

## Sliding Slim

- Desk mounted screens when there is minimal gap, of 2mm between desk tops.
- Screw fixings supplied.
- Not to be used with screen hung monitor arms.

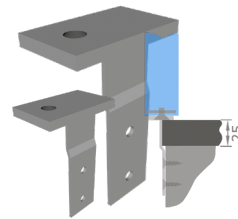

## Sliding Slab end

- When attaching onto a pedestal or cupboard back.
- Screw fixings supplied.
- Not to be used with screen hung monitor arms.

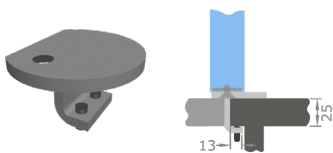

## Sliding interference

- When there is interference below a desk top close to the edge.
- Usable jaw size of 21-25mm.
- Supplied with two grub screws.
- Not to be used with screen hung monitor arms.

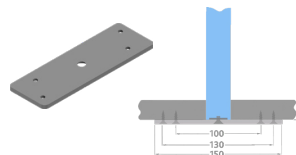

## Sliding Bench bracket

- For use when attaching desk mounted screens to a double sided bench with a 30mm gap between the desk tops.
- Screw fixings supplied.
- Bracket positions screen inline with underside of the desk tops.
- Not to be used with screen hung monitor arms.

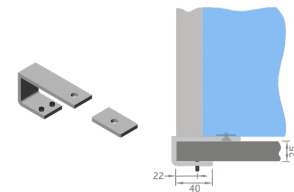

## Sliding desk edge bracket

- For use when attaching return desk mounted screens around the front edge of a desk top.
- For Border, F30 and Origin+ screens.
- Usable jaw size of 21-25mm.
- Supplied with one sliding spacer and two grub screws.